

SECTION VIEW

NTS

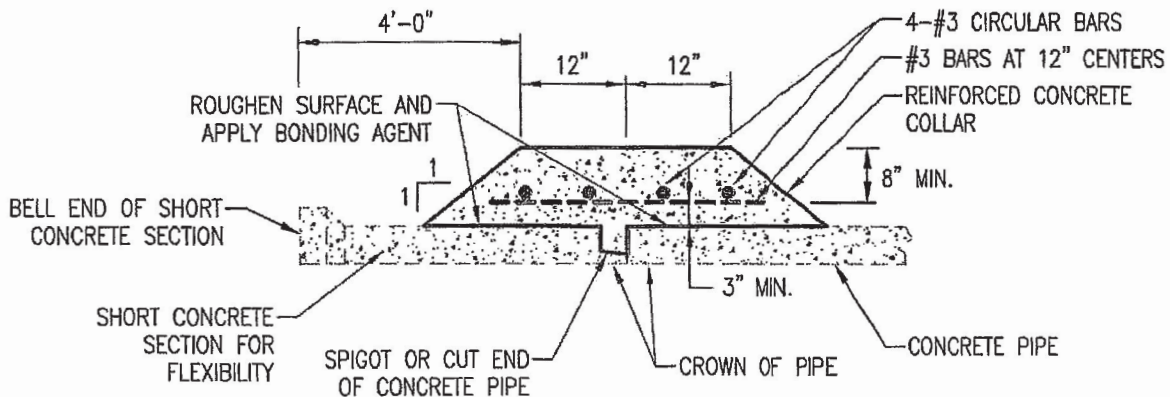

CONCRETE PIPE COLLAR

NTS

NOTES:

1. JOINTS TO BE SANDBLASTED, WASHED THOROUGHLY WITH AIR-WATER JETS AND SURFACE DRIED. PRIOR TO PLACING CONCRETE COLLAR.
2. JUST PRIOR TO PLACEMENT, THE CLEANED CONCRETE SURFACE SHALL BE COATED WITH AN EPOXY MEETING THE REQUIREMENTS OF ASTM 881. THE CONCRETE SHALL BE PLACE WITHIN 30 MINUTES AFTER THE EPOXY IS APPLIED.
3. REINFORCEMENT: GRADE 60 CONCRETE 3000 PSI MINIMUM (28 DAYS).
4. THE INSIDE OF JOINT TO BE PACKED AND FINISHED BY THE CONTRACTOR.
5. THE COLLAR SHALL BE CURED TO PREVENT CRACKING.
6. COLLAR SHALL BE CONTINUOUS (360°) AROUND CIRCUMFERENCE OF PIPE.
7. AT THE CONNECTION POINT, THE EXISTING PIPELINES SHALL BE SAWCUT PRIOR TO CONSTRUCTING THE CONNECTION COLLAR IF NEEDED
8. VERIFY END TYPE OF EXISTING PIPE AND USE PREFABRICATED JOINT WHERE FEASIBLE IN-LIEU OF PIPE COLLAR.